

# ALDER HEY CHILDRENS HOSPITAL Institute in the Park (Phase 1)



**Client:** Morgan Sindall Construction

**Value:** £320,000.00



▲ Superstructure timber works

▲ Feature bespoke Douglas-Fir wall, ceiling and stair cladding

▲ Specialist acoustic wall panels

▲ MDF mouldings

▲ Domestic kitchen areas

▲ External non-slip timber decking

▲ Bespoke architectural performance doorsets:

Acoustic

Fire

▲ Architectural expert ironmongery

▲ Temporary, structural & build-up works

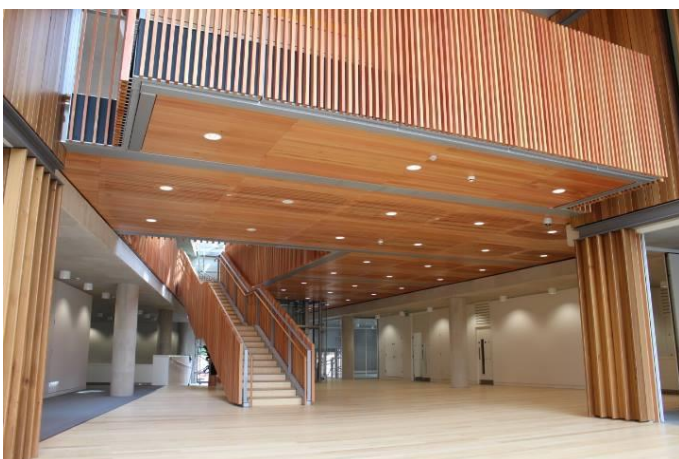
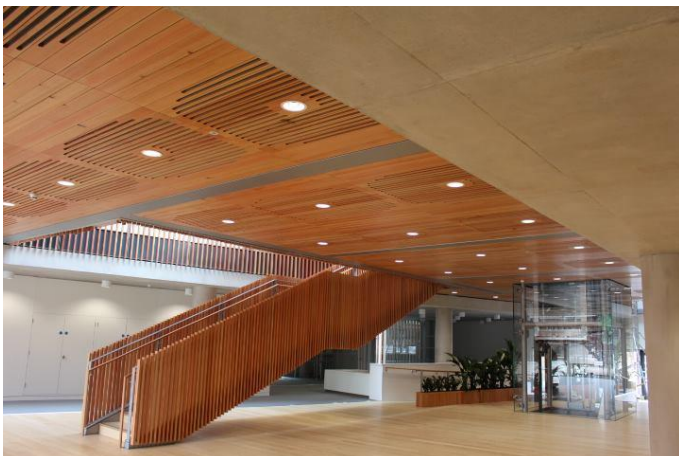

### ***Project challenges:***

Factory finished doorsets, keeping damage to a minimum once installed

Fine router detailing to timber cladding, minimal margins to work to, needed maximum attention to detail and excellent craftsmanship

Complex programme of trades attending site, each impacting on each other's works in terms of tolerances, margins and timescales